

# Hemily

TOOL SUPPLY INC.

2012 TOOLHOLDERS  
AND ACCESSORIES

ER collet toolholders  
ER collets inch and metric  
endmill holders  
shell mill arbors  
TG 100 holders and collets  
morse taper holders  
drill chucks and arbors  
tap holders and collets  
retention knobs  
hand wrenches and setup equipment

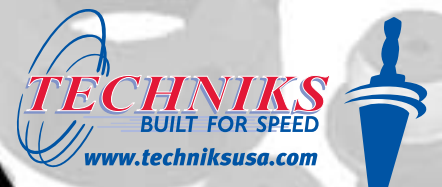

# CAT40 Precision ER Collet Chucks



Standard style chuck

- **Balanced to 25,000 RPM at G2.5**
- **T.I.R. 0.0001"**
- **Power Coat nut included**

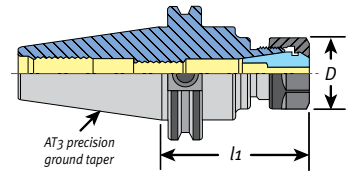

ER Mini Nut style chuck for tighter nose clearance



## CAT40 – ER11 thru ER50 Standard Collet Chucks

Part No.	Description	l1	D	Max. Shank	Wrench	Price	Sale Price
22213-3	CAT 40 x ER 11 - 3", hex nut	3"	.748"	.275"	04608	\$143.00	<b>\$110.00</b>
22225	CAT 40 x ER 16 - 2.76", hex nut	2.76"	1.08"	.406"	04609	\$143.00	<b>\$95.00</b>
22227	CAT 40 x ER 16 - 4", hex nut	4"	1.08"	.406"	04609	\$145.00	<b>\$105.00</b>
22231	CAT 40 x ER 16 - 6", hex nut	6"	1.08"	.406"	04609	\$160.00	<b>\$125.00</b>
22233	CAT 40 x ER 16 - 8", hex nut	8"	1.08"	.406"	04609	\$180.00	<b>\$145.00</b>
22235	CAT 40 x ER 20 - 2.76", hex nut	2.76"	1.34"	.512"	04610	\$143.00	<b>\$95.00</b>
22237	CAT 40 x ER 20 - 4", hex nut	4"	1.34"	.512"	04610	\$145.00	<b>\$105.00</b>
22239	CAT 40 x ER 20 - 6", hex nut	6"	1.34"	.512"	04610	\$167.00	<b>\$125.00</b>
22243-2.5	CAT 40 x ER 25 - 2.5", slotted nut	2.5"	1.65"	.630"	04615	\$143.00	<b>\$110.00</b>
22243	CAT 40 x ER 25 - 2.76", slotted nut	2.76"	1.65"	.630"	04615	\$143.00	<b>\$110.00</b>
22245	CAT 40 x ER 25 - 4", slotted nut	4"	1.65"	.630"	04615	\$155.00	<b>\$125.00</b>
22247	CAT 40 x ER 25 - 6", slotted nut	6"	1.65"	.630"	04615	\$160.00	<b>\$125.00</b>
22251	CAT 40 x ER 25 - 8", slotted nut	8"	1.65"	.630"	04615	\$180.00	<b>\$145.00</b>
22253	CAT 40 x ER 32 - 2.76", slotted nut	2.76"	1.97"	.788"	04616	\$153.00	<b>\$105.00</b>
22255	CAT 40 x ER 32 - 4", slotted nut	4"	1.97"	.788"	04616	\$153.00	<b>\$105.00</b>
22257	CAT 40 x ER 32 - 6", slotted nut	6"	1.97"	.788"	04616	\$174.00	<b>\$135.00</b>
22259	CAT 40 x ER 32 - 8", slotted nut	8"	1.97"	.788"	04616	\$195.00	<b>\$150.00</b>
22261	CAT 40 x ER 40 - 3.15", slotted nut	3.15"	2.48"	1.023"	04617	\$160.00	<b>\$125.00</b>
22263	CAT 40 x ER 40 - 4", slotted nut	4"	2.48"	1.023"	04617	\$160.00	<b>\$125.00</b>
22265	CAT 40 x ER 40 - 6", slotted nut	6"	2.48"	1.023"	04617	\$190.00	<b>\$150.00</b>
22269	CAT 40 x ER 50 - 4", slotted nut	4"	3.07"	1.338"	04618	\$200.00	<b>\$160.00</b>

## CAT40 – ER11 thru ER20 Mini Nut Style Collet Chucks

Part No.	Description	l1	D	Max. Shank	Wrench	Price	Sale Price
22352	CAT 40 x ER 11 - 2.75", mini nut	2.75"	.63"	.275"	04621	\$160.00	<b>\$125.00</b>
22354	CAT 40 x ER 11 - 4", mini nut	4"	.63"	.275"	04621	\$164.00	<b>\$130.00</b>
22354-6	CAT 40 x ER 11 - 6", mini nut	6"	.63"	.275"	04621	\$300.00	<b>\$240.00</b>
22354-8.5	CAT 40 x ER 11 - 8.5", mini nut	8.5"	.63"	.275"	04621	\$429.00	<b>\$340.00</b>
22356	CAT 40 x ER 16 - 2.76", mini nut	2.76"	.87"	.406"	04622	\$164.00	<b>\$130.00</b>
22358	CAT 40 x ER 16 - 4", mini nut	4"	.87"	.406"	04622	\$168.00	<b>\$135.00</b>
22359	CAT 40 x ER 16 - 6", mini nut	6"	.87"	.406"	04622	\$138.00	<b>\$110.00</b>
22359-8	CAT 40 x ER 16 - 8", mini nut	8"	.87"	.406"	04622	\$315.00	<b>\$250.00</b>
22360	CAT 40 x ER 20 - 2.76", mini nut	2.76"	1.102"	.512"	04623	\$168.00	<b>\$135.00</b>
22362	CAT 40 x ER 20 - 4", mini nut	4"	1.102"	.512"	04623	\$169.00	<b>\$135.00</b>

# CAT50 Precision ER Collet Chucks



## CAT 50 ER16 thru ER50 Standard Collet Chucks

Part No.	Description	l1	D	Max. Shank	Wrench	Price	Sale Price
22281	CAT 50 x ER 16 - 4", hex nut	4"	1.08"	.406"	04609	\$175.00	<b>\$140.00</b>
22285	CAT 50 x ER 16 - 6", hex nut	6"	1.08"	.406"	04609	\$190.00	<b>\$150.00</b>
22287	CAT 50 x ER 16 - 8", hex nut	8"	1.08"	.406"	04609	\$250.00	<b>\$200.00</b>
22291	CAT 50 x ER 20 - 4", hex nut	4"	1.34"	.512"	04610	\$180.00	<b>\$145.00</b>
22293	CAT 50 x ER 20 - 6", hex nut	6"	1.34"	.512"	04610	\$180.00	<b>\$145.00</b>
22295	CAT 50 x ER 20 - 8", hex nut	8"	1.34"	.512"	04610	\$250.00	<b>\$200.00</b>
22303	CAT 50 x ER 25 - 4", slotted nut	4"	1.65"	.630"	04615	\$170.00	<b>\$135.00</b>
22305	CAT 50 x ER 25 - 6", slotted nut	6"	1.65"	.630"	04615	\$189.00	<b>\$150.00</b>
22307	CAT 50 x ER 25 - 8", slotted nut	8"	1.65"	.630"	04615	\$250.00	<b>\$200.00</b>
22311	CAT 50 x ER 32 - 4", slotted nut	4"	1.97"	.788"	04616	\$170.00	<b>\$135.00</b>
22313	CAT 50 x ER 32 - 6", slotted nut	6"	1.97"	.788"	04616	\$199.00	<b>\$160.00</b>
22317	CAT 50 x ER 32 - 8", slotted nut	8"	1.97"	.788"	04616	\$225.00	<b>\$180.00</b>
22321	CAT 50 x ER 40 - 4", slotted nut	4"	2.48"	1.023"	04617	\$180.00	<b>\$145.00</b>
22325	CAT 50 x ER 40 - 6", slotted nut	6"	2.48"	1.023"	04617	\$210.00	<b>\$170.00</b>
22327	CAT 50 x ER 40 - 8", slotted nut	8"	2.48"	1.023"	04617	\$266.00	<b>\$215.00</b>
22331	CAT 50 x ER 50 - 4", slotted nut	4"	3.07"	1.338"	04618	\$266.00	<b>\$215.00</b>
22335	CAT 50 x ER 50 - 6", slotted nut	6"	3.07"	1.338"	04618	\$301.00	<b>\$240.00</b>
22337	CAT 50 x ER 50 - 8", slotted nut	8"	3.07"	1.338"	04618	\$322.00	<b>\$255.00</b>

## CAT 50 ER16 thru ER20 Mini Nut Style Collet Chucks

Part No.	Description	l1	D	Max. Shank	Wrench	Price	Sale Price
22364	CAT 50 x ER 16 - 4", mini nut	4"	.87"	.406"	04622	\$225.00	<b>\$180.00</b>
22366	CAT 50 x ER 16 - 6", mini nut	6"	.87"	.406"	04622	\$313.00	<b>\$250.00</b>
22368	CAT 50 x ER 20 - 4", mini nut	4"	1.102"	.512"	04623	\$284.00	<b>\$225.00</b>
22370	CAT 50 x ER 20 - 6", mini nut	6"	1.102"	.512"	04623	\$325.00	<b>\$260.00</b>

# CAT40 & CAT50 Super-Rigid ER Collet Chucks



- **Balanced to 25,000 RPM at G2.5**
- **Rigid design for heavy side loads**
- **Use with standard ER 32 collets**

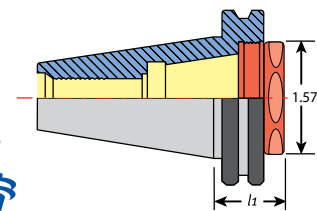

Maximum rigidity and T.I.R. for best performance. Ideal for high speed or high torque.

Part No.	Description	l1	Collet	Max. Shank	Wrench	Price	Sale Price
TE-22253S	CAT 40 Super-Rigid x ER 32	1.10"	ER 32	3/4" or 20mm	894-36	\$126.00	<b>\$100.00</b>
TE-22311S	CAT 50 Super-Rigid x ER 32	1.10"	ER 32	3/4" or 20mm	894-36	\$165.00	<b>\$130.00</b>

# CAT40 Precision End Mill Holders



Standard style

- High precision bore (H5)
- Balanced to 10,000 RPM
- Metric sizes available

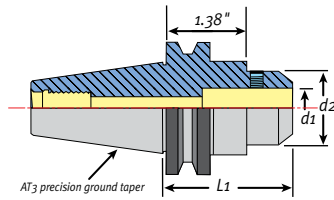

Extended style



## CAT 40 Standard Length End Mill Holders Inch Size

Part No.	Description	d1	L1	d2	Price	Sale Price
22907	CAT 40 x 1/8" I.D. - 2.37"	1/8"	2.37"	.69"	\$85.00	<b>\$70.00</b>
22909	CAT 40 x 3/16" I.D. - 2.5"	3/16"	2.5"	.69"	\$85.00	<b>\$70.00</b>
22911	CAT 40 x 1/4" I.D. - 3"	1/4"	3"	.78"	\$85.00	<b>\$70.00</b>
22911-2.5	CAT 40 x 1/4" I.D. - 2.5	1/4"	2.5"	.78"	\$85.00	<b>\$70.00</b>
22913	CAT 40 x 5/16" I.D. - 3"	5/16"	3"	.88"	\$85.00	<b>\$70.00</b>
22913-2.5	CAT 40 x 5/16" I.D. - 2.5"	5/16"	2.5"	.88"	\$95.00	<b>\$75.00</b>
22915	CAT 40 x 3/8" I.D. - 3"	3/8"	3"	1.0"	\$85.00	<b>\$70.00</b>
22915-2.5	CAT 40 x 3/8" I.D. - 2.5"	3/8"	2.5"	1.0"	\$95.00	<b>\$75.00</b>
22916	CAT 40 x 7/16" I.D. - 2.5"	7/16"	2.5"	1.13"	\$85.00	<b>\$70.00</b>
22917	CAT 40 x 1/2" I.D. - 3"	1/2"	3"	1.25"	\$85.00	<b>\$70.00</b>
22917-2.5	CAT 40 x 1/2" I.D. - 2.5"	1/2"	2.5"	1.25"	\$85.00	<b>\$70.00</b>
22917-2.63	CAT 40 x 1/2" I.D. - 2.63"	1/2"	2.63"	1.25"	\$85.00	<b>\$70.00</b>
22919	CAT 40 x 5/8" I.D. - 3"	5/8"	3"	1.5"	\$85.00	<b>\$70.00</b>
22920	CAT 40 x 5/8" I.D. - 3.75"	5/8"	3.75"	1.5"	\$95.00	<b>\$75.00</b>
22921	CAT 40 x 3/4" I.D. - 3.5"	3/4"	3.5"	1.75"	\$85.00	<b>\$70.00</b>
22921-3	CAT 40 x 3/4" I.D. - 3"	3/4"	3"	1.75"	\$85.00	<b>\$70.00</b>
22923	CAT 40 x 7/8" I.D. - 3.5"	7/8"	3.5"	1.88"	\$95.00	<b>\$75.00</b>
22925-3	CAT 40 x 1.0" I.D. - 3"	1.0"	3"	2"	\$114.00	<b>\$90.00</b>
22925	CAT 40 x 1.0" I.D. - 4"	1.0"	4"	2"	\$95.00	<b>\$75.00</b>
22927	CAT 40 x 1.25" I.D. - 4.6"	1.25"	4.6"	2.5"	\$105.00	<b>\$85.00</b>
22927-4	CAT 40 x 1.25" I.D. - 4"	1.25"	4"	2.5"	\$105.00	<b>\$85.00</b>
22929	CAT 40 x 1.5" I.D. - 4.5"	1.5"	4.5"	2.5"	\$120.00	<b>\$95.00</b>

## CAT 40 Extended Length End Mill Holders

Part No.	Description	d1	L1	d2	Price	Sale Price
22907-6	CAT 40 x 1/8" I.D. - 6"	1/8"	6"	.69"	\$115.00	<b>\$90.00</b>
22909-6	CAT 40 x 3/16" I.D. - 6"	3/16"	6"	.69"	\$115.00	<b>\$90.00</b>
22911-6	CAT 40 x 1/4" I.D. - 6"	1/4"	6"	.78"	\$105.00	<b>\$85.00</b>
22915-5	CAT 40 x 3/8" I.D. - 5"	3/8"	5"	1.0"	\$155.00	<b>\$125.00</b>
22917-4.63	CAT 40 x 1/2" I.D. - 4.63"	1/2"	4.63"	1.25"	\$110.00	<b>\$85.00</b>
22920-5.75	CAT 40 x 5/8" I.D. - 5.75"	5/8"	5.75"	1.5"	\$122.50	<b>\$95.00</b>
22921-5	CAT 40 x 3/4" I.D. - 5"	3/4"	5"	1.75"	\$115.00	<b>\$90.00</b>
22925-6	CAT 40 x 1.0" I.D. - 6"	1.0"	6"	2"	\$135.00	<b>\$110.00</b>
22927-6	CAT 40 x 1 -1/4" I.D. - 6"	1 -1/4"	6"	2.5"	\$150.00	<b>\$120.00</b>

## CAT 40 Stubby Length End Mill Holders (continued next page)

Part No.	Description	d1	L1	d2	Price	Sale Price
22907-1.75	CAT 40 x 1/8" I.D. - 1.75"	1/8"	1.75"	.75"	\$95.00	<b>\$75.00</b>
22909-1.75	CAT 40 x 3/16" I.D. - 1.75"	3/16"	1.75"	.79"	\$95.00	<b>\$75.00</b>
22911-1.75	CAT 40 x 1/4" I.D. - 1.75"	1/4"	1.75"	.79"	\$85.00	<b>\$70.00</b>
22913-1.75	CAT 40 x 5/16" I.D. - 1.75"	5/16"	1.75"	.88"	\$95.00	<b>\$75.00</b>
22915-1.75	CAT 40 x 3/8" I.D. - 1.75"	3/8"	1.75"	.88"	\$85.00	<b>\$70.00</b>

# CAT40 & CAT50 End Mill Holders



## (cont.) CAT 40 Stubby Length

Part No.	Description	d1	L1	d2	Price	Sale Price
22916-1.75	CAT 40 x 7/16" I.D. - 1.75"	7/16"	1.75"	1.12"	\$95.00	<b>\$75.00</b>
22917-1.75	CAT 40 x 1/2" I.D. - 1.75"	1/2"	1.75"	1.50"	\$85.00	<b>\$70.00</b>
22919-1.75	CAT 40 x 5/8" I.D. - 1.75"	5/8"	1.75"	1.50"	\$85.00	<b>\$70.00</b>
22921-1.75	CAT 40 x 3/4" I.D. - 1.75"	3/4"	1.75"	1.75"	\$95.00	<b>\$75.00</b>
22925A-1.75	CAT 40 x 1.0" I.D. - 1.75"	1.0"	1.75"	2"	\$95.00	<b>\$75.00</b>
22927A-2	CAT 40 x 1-1/4" I.D. - 2"	1-1/4"	2"	2.5"	\$105.00	<b>\$85.00</b>

## CAT 50 Standard Length End Mill Holders Inch Size

Part No.	Description	d1	L1	d2	Price	Sale Price
22931	CAT 50 x 1/4" I.D. - 4"	1/4"	4"	.78"	\$130.00	<b>\$105.00</b>
22933	CAT 50 x 5/16" I.D. - 4"	5/16"	4"	.88"	\$130.00	<b>\$105.00</b>
22935	CAT 50 x 3/8" I.D. - 4"	3/8"	4"	1.0"	\$130.00	<b>\$105.00</b>
22937	CAT 50 x 1/2" I.D. - 4"	1/2"	4"	1.25"	\$130.00	<b>\$105.00</b>
22939-3	CAT 50 x 5/8" I.D. - 3"	5/8"	3"	1.5"	\$130.00	<b>\$105.00</b>
22939	CAT 50 x 5/8" I.D. - 4"	5/8"	4"	1.5"	\$130.00	<b>\$105.00</b>
22941-3	CAT 50 x 3/4" I.D. - 3"	3/4"	3"	1.75"	\$130.00	<b>\$105.00</b>
22941	CAT 50 x 3/4" I.D. - 4"	3/4"	4"	1.75"	\$130.00	<b>\$105.00</b>
22943	CAT 50 x 7/8" I.D. - 4"	7/8"	4"	1.88"	\$130.00	<b>\$105.00</b>
22943-6	CAT 50 x 7/8" I.D. - 6"	7/8"	6"	1.88"	\$300.00	<b>\$240.00</b>
22945	CAT 50 x 1.0" I.D. - 4"	1.0"	4"	2"	\$130.00	<b>\$105.00</b>
22947	CAT 50 x 1-1/4" I.D. - 4.6"	1-1/4"	4.6"	2.5"	\$134.00	<b>\$105.00</b>
22949	CAT 50 x 1-1/2" I.D. - 4.6"	1-1/2"	4.6"	2.5"	\$134.00	<b>\$105.00</b>
22951	CAT 50 x 2" I.D. - 6"	2"	6"	3.75"	\$169.00	<b>\$135.00</b>

## CAT 50 Extended Length End Mill Holders

Part No.	Description	d1	L1	d2	Price	Sale Price
22935-6	CAT 50 x 3/8" I.D. - 6"	3/8"	6"	1.0"	\$147.00	<b>\$115.00</b>
22936-8	CAT 50 x 3/8" I.D. - 8"	3/8"	8"	1.0"	\$170.00	<b>\$135.00</b>
22937-6	CAT 50 x 1/2" I.D. - 6"	1/2"	6"	1.25"	\$150.00	<b>\$120.00</b>
22937-8	CAT 50 x 1/2" I.D. - 8"	1/2"	8"	1.25"	\$173.00	<b>\$135.00</b>
22939-6	CAT 50 x 5/8" I.D. - 6"	5/8"	6"	1.5"	\$150.00	<b>\$120.00</b>
22939-8	CAT 50 x 5/8" I.D. - 8"	5/8"	8"	1.5"	\$173.00	<b>\$135.00</b>
22941-6	CAT 50 x 3/4" I.D. - 6"	3/4"	6"	1.75"	\$150.00	<b>\$120.00</b>
22941-8	CAT 50 x 3/4" I.D. - 8"	3/4"	8"	1.75"	\$173.00	<b>\$135.00</b>
22945-6	CAT 50 x 1.0" I.D. - 6"	1.0"	6"	2"	\$135.00	<b>\$105.00</b>
22946-8	CAT 50 x 1.0" I.D. - 8"	1.0"	8"	2"	\$156.00	<b>\$120.00</b>

## CAT 50 Stubby Length End Mill Holders

Part No.	Description	d1	L1	d2	Price	Sale Price
22931-2 1/2	CAT 50 x 1/4" I.D. - 2.5"	1/4"	2.5"	.78"	\$112.00	<b>\$90.00</b>
22935-2 1/2	CAT 50 x 3/8" I.D. - 2.5"	3/8"	2.5"	1.0"	\$112.00	<b>\$90.00</b>
22937-2 5/8	CAT 50 x 1/2" I.D. - 2.67"	1/2"	2.67"	1.5"	\$112.00	<b>\$90.00</b>
22939-1.44	CAT 50 x 5/8" I.D. - 1.44"	5/8"	1.44"	1.5"	\$130.00	<b>\$105.00</b>
22941-1.44	CAT 50 x 3/4" I.D. - 1.44"	3/4"	1.44"	1.75"	\$130.00	<b>\$105.00</b>
22945-2.62	CAT 50 x 1.0" I.D. - 2.62"	1"	2.62"	2"	\$150.00	<b>\$120.00</b>
22947-2.62	CAT 50 x 1-1/4" I.D. - 2.62"	1-1/4"	2.62"	2.5"	\$150.00	<b>\$120.00</b>
22949-2	CAT 50 x 1-1/2" I.D. - 2"	1-1/2"	2"	2.75"	\$134.00	<b>\$105.00</b>

# CAT40 and CAT50 Precision Shell Mill Arbors



- H6 arbor tolerance for less chatter and better tool life
- Each arbor lab certified for accuracy
- Taper ground to AT3 tolerance or better

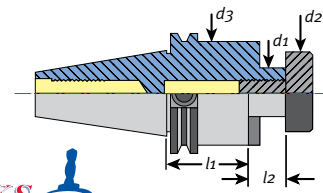

## CAT 40 Shell Mill Arbors

Part No.	Description	l1	l2	d1	d2	d3	K2	Price	Sale Price
22709	CAT 40 x 1/2" arbor - 1.37"	1.37"	.55"	1/2"	.66"	1.45"	.25"	\$123.00	<b>\$95.00</b>
22709-4	CAT 40 x 1/2" arbor - 4"	4"	.55"	1/2"	.66"	1.45"	.25"	\$175.00	<b>\$140.00</b>
22711	CAT 40 x 3/4" arbor - 1.37"	1.37"	.69"	3/4"	.88"	1.69"	.31"	\$112.00	<b>\$90.00</b>
22711-4	CAT 40 x 3/4" arbor - 4.0"	4"	.69"	3/4"	.88"	1.69"	.31"	\$150.00	<b>\$120.00</b>
22711-6	CAT 40 x 3/4" arbor - 6.0"	6"	.69"	3/4"	.88"	1.69"	.31"	\$170.00	<b>\$135.00</b>
22713	CAT 40 x 1.0" arbor - 2.06"	2.06"	.69"	1.0"	1.19"	2.2"	.38"	\$112.00	<b>\$90.00</b>
22713-4	CAT 40 x 1.0" arbor - 4.0"	4"	.69"	1.0"	1.19"	2.2"	.38"	\$150.00	<b>\$120.00</b>
22713-6	CAT 40 x 1.0" arbor - 6.0"	6"	.69"	1.0"	1.19"	2.2"	.38"	\$170.00	<b>\$135.00</b>
22715	CAT 40 x 1-1/4" arbor - 2.21"	2.21"	.69"	1-1/4"	1.5"	2.75"	.5"	\$119.00	<b>\$95.00</b>
22715-4	CAT 40 x 1-1/4" arbor - 4.0"	4"	.69"	1-1/4"	1.5"	2.75"	.5"	\$170.00	<b>\$135.00</b>
22715-6	CAT 40 x 1-1/4" arbor - 6.0"	6"	.69"	1-1/4"	1.5"	3."	.5"	\$175.00	<b>\$140.00</b>
22717	CAT 40 x 1-1/2" arbor - 2.21"	2.21"	.94"	1-1/2"	1.88"	3.8"	.63"	\$133.00	<b>\$105.00</b>
22717-4	CAT 40 x 1-1/2" arbor - 4"	4"	.94"	1-1/2"	1.88"	3.8"	.63"	\$190.00	<b>\$150.00</b>

## CAT 50 Shell Mill Arbors

Part No.	Description	l1	l2	d1	d2	d3	K2	Price	Sale Price
22719	CAT 50 x 1/2" arbor - 1.5"	1.5"	.055"	1/2"	.66"	1.45"	.25"	\$175.00	<b>\$140.00</b>
22721	CAT 50 x 3/4" arbor - 1.5"	1.5"	.69"	3/4"	.88"	2.75"	.31"	\$135.00	<b>\$105.00</b>
22721-3.5	CAT 50 x 3/4" arbor - 3.5"	3.5"	.69"	3/4"	.88"	1.69"	.31"	\$175.00	<b>\$140.00</b>
22721-5.5	CAT 50 x 3/4" arbor - 5.5"	5.5"	.69"	3/4"	.88"	1.69"	.31"	\$225.00	<b>\$180.00</b>
22721-8	CAT 50 x 3/4" arbor - 8"	8"	.69"	3/4"	.88"	1.69"	.31"	\$280.00	<b>\$225.00</b>
22721-10	CAT 50 x 3/4" arbor - 10"	10"	.69"	3/4"	.88"	1.69"	.31"	\$368.00	<b>\$295.00</b>
22723	CAT 50 x 1" arbor - 2.0"	2.0"	.69"	1.0"	1.19"	2.2"	.38"	\$140.00	<b>\$110.00</b>
22723-4	CAT 50 x 1" arbor - 4.0"	4"	.69"	1.0"	1.19"	2.2"	.38"	\$190.00	<b>\$150.00</b>
22723-6	CAT 50 x 1" arbor - 6.0"	6"	.69"	1.0"	1.19"	2.2"	.38"	\$245.00	<b>\$195.00</b>
22723-8	CAT 50 x 1" arbor - 8.0"	8"	.69"	1.0"	1.19"	2.2"	.38"	\$280.00	<b>\$225.00</b>
22723-10	CAT 50 x 1" arbor - 10.0"	10"	.69"	1.0"	1.19"	2.2"	.38"	\$368.00	<b>\$295.00</b>
22725	CAT 50 x 1-1/4" arbor - 1.50"	1.5"	.69"	1-1/4"	1.5"	2.75"	.5"	\$159.00	<b>\$125.00</b>
22725-3.5	CAT 50 x 1-1/4" arbor - 3.5"	3.5"	.69"	1-1/4"	1.5"	2.75"	.5"	\$190.00	<b>\$150.00</b>
22725-6	CAT 50 x 1-1/4" arbor - 6.0"	6"	.69"	1-1/4"	1.5"	2.75"	.5"	\$245.00	<b>\$195.00</b>
22725-8	CAT 50 x 1-1/4" arbor - 8.0"	8"	.69"	1-1/4"	1.5"	2.75"	.5"	\$298.00	<b>\$235.00</b>
22727	CAT 50 x 1-1/2" arbor - 2.4"	2.4"	.94"	1-1/2"	1.88"	3.8"	.63"	\$159.00	<b>\$125.00</b>
22727-4	CAT 50 x 1-1/2" arbor - 4.0"	4"	.94"	1-1/2"	1.88"	3.8"	.63"	\$190.00	<b>\$150.00</b>
22727-6	CAT 50 x 1-1/2" arbor - 6.0"	6"	.94"	1-1/2"	1.88"	3.8"	.63"	\$245.00	<b>\$195.00</b>
22727-8	CAT 50 x 1-1/2" arbor - 8.0"	8"	.94"	1-1/2"	1.88"	3.8"	.63"	\$318.00	<b>\$255.00</b>
22729	CAT 50 x 2" arbor - 2.4"	2.4"	.94"	2"	2.5"	4.88"	.75"	\$200.00	<b>\$160.00</b>
22729-4	CAT 50 x 2" arbor - 4.0"	4"	.94"	2"	2.5"	4.88"	.75"	\$360.00	<b>\$285.00</b>

# TG 100 Holders, Collets, & Nuts



- **Balanced to 25,000 RPM at G2.5**
- **T.I.R. 0.0001" measured from taper to collet pocket**
- **Power Coat nut included**

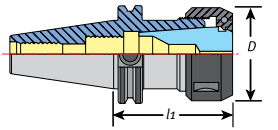

## TG 100 Precision Tool Holders

Part No.	Description	l1	D	Wrench	Price	Sale Price
23014	CAT40 x TG 100 - 3"	3"	2.362"	03691	\$105.00	<b>\$85.00</b>
23016	CAT40 x TG 100 - 4"	4"	2.362"	03691	\$110.00	<b>\$90.00</b>
23018	CAT40 x TG 100 - 6"	6"	2.362"	03691	\$120.00	<b>\$95.00</b>
23030	CAT50 x TG 100 - 3"	3"	2.362"	03691	\$145.00	<b>\$115.00</b>
23032	CAT50 x TG 100 - 4"	4"	2.362"	03691	\$180.00	<b>\$145.00</b>
23034	CAT50 x TG 100 - 6"	6"	2.362"	03691	\$198.00	<b>\$160.00</b>
23035	CAT50 x TG 100 - 8"	8"	2.362"	03691	\$275.00	<b>\$220.00</b>

## TG 100 Collets

- **.0004" T.I.R.**
- **Precision ground & hand inspected**
- **Clamping range: 1/64"**



Part No.	Shank
04010-3/32	3/32"
04010-7/64	7/64"
04010-1/8	1/8"
04010-9/64	9/64"
04010-5/32	5/32"
04010-11/64	11/64"
04010-3/16	3/16"
04010-13/64	13/64"
04010-7/32	7/32"
04010-15/64	15/64"
04010-1/4	1/4"
04010-17/64	17/64"
04010-9/32	9/32"
04010-19/64	19/64"
04010-5/16	5/16"

## TG 100 Collet Sets and TG 100 Wrench

Part No.	Pcs.	ID Sizes	Sale Price
04010-59S	59	3/32 - 1" by 64 <sup>ths</sup>	<b>\$737.50</b>
04010-41S	41	3/8 - 1" by 64 <sup>ths</sup>	<b>\$522.75</b>
04010-30S	30	3/32 - 1" by 32 <sup>nds</sup>	<b>\$390.00</b>

Part No.	Pcs.	ID Sizes	Sale Price
04010-21S	21	3/8 - 1" by 32 <sup>nds</sup>	<b>\$278.25</b>
04010-15S	15	1/8 - 1" by 16 <sup>ths</sup>	<b>\$202.50</b>
03691		TG 100 hook wrench	<b>\$15.00</b>

Part No.	Shank	Part No.	Shank	Part No.	Shank	Part No.	Shank
04010-9/16	9/16"	04010-21/64	21/64"	04010-9/16	9/16"	04010-51/64	51/64"
04010-37/64	37/64"	04010-11/32	11/32"	04010-37/64	37/64"	04010-13/16	13/16"
04010-19/32	19/32"	04010-23/64	23/64"	04010-19/32	19/32"	04010-53/64	53/64"
04010-39/64	39/64"	04010-3/8	3/8"	04010-39/64	39/64"	04010-27/32	27/32"
04010-5/8	5/8"	04010-25/64	25/64"	04010-5/8	5/8"	04010-55/64	55/64"
04010-41/64	41/64"	04010-13/32	13/32"	04010-41/64	41/64"	04010-7/8	7/8"
04010-21/32	21/32"	04010-27/64	27/64"	04010-21/32	21/32"	04010-57/64	57/64"
04010-43/64	43/64"	04010-7/16	7/16"	04010-43/64	43/64"	04010-29/32	29/32"
04010-11/16	11/16"	04010-29/64	29/64"	04010-11/16	11/16"	04010-59/64	59/64"
04010-45/64	45/64"	04010-15/32	15/32"	04010-45/64	45/64"	04010-15/16	15/16"
04010-23/32	23/32"	04010-31/64	31/64"	04010-23/32	23/32"	04010-61/64	61/64"
04010-47/64	47/64"	04010-1/2	1/2"	04010-47/64	47/64"	04010-31/32	31/32"
04010-3/4	3/4"	04010-33/64	33/64"	04010-3/4	3/4"	04010-63/64	63/64"
04010-49/64	49/64"	04010-17/32	17/32"	04010-49/64	49/64"	04010-1	1.0"
04010-25/32	25/32"	04010-35/64	35/64"	04010-25/32	25/32"		

## TG 100 Coolant Collets



- **Up to 750 PSI coolant**
- **Clamping range: 1/64"**

Coolant collets require coolant style nut, and ER 32 coolant ring. Request coolant rings sized to match your tool shank.

Part No.	Shank	Part No.	Shank	Part No.	Shank	Part No.	Shank
84063-1/4	1/4"	84063-7/16	7/16"	84063-5/8	5/8"	84063-13/16	13/16"
84063-9/32	9/32"	84063-15/32	15/32"	84063-21/32	21/32"	84063-27/32	27/32"
84063-5/16	5/16"	84063-1/2	1/2"	84063-11/16	11/16"	84063-7/8	7/8"
84063-11/32	11/32"	84063-17/32	17/32"	84063-23/32	23/32"	84063-29/32	29/32"
84063-3/8	3/8"	84063-9/16	9/16"	84063-3/4	3/4"	84063-15/16	15/16"
84063-13/32	13/32"	84063-19/32	19/32"	84063-25/32	25/32"	84063-31/32	31/32"
						84063-1	1.0"

# Drill Chucks & Jacobs Taper Drill Chuck Arbors



- 3 times more holding power than other chucks
- Holds non-standard shank sizes up to 1/2"
- Replaceable chuck is held by a drawbolt

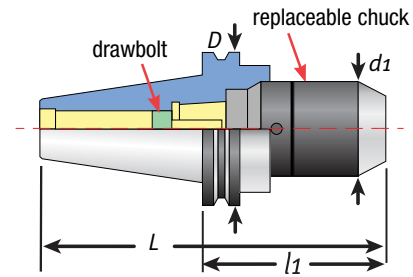

## CAT and BT SPU Drill Chucks

Part No.	Description	l1	L	D	d1	Price	Sale Price
22403	CAT 40 SPU x 1/2" - 4"	101.6mm	169.9mm	63.5mm	50mm	\$228.00	<b>\$155.00</b>
22405	CAT 50 SPU x 1/2" - 4"	101.6mm	203.2mm	98.4mm	50mm	\$280.00	<b>\$225.00</b>
01250-13S	replacement wrench					\$5.00	<b>\$4.00</b>



- For milling machines & drilling machines
- All hardened parts for long life and safety
- Use with CAT or BT holders



## Keyless Jacobs Taper Replacement Drill Chucks

Part No.	Type	Length Closed	Outer Diameter	Range	Price	Sale Price
02150	08S x JT1	76mm	38mm	0 - 5/16"	\$102.00	<b>\$80.00</b>
02153	13S x JT6	102mm	49mm	0 - 1/2"	\$133.00	<b>\$105.00</b>
02151-JT33	10S x JT33	92mm	43mm	0 - 3/8"	\$102.50	<b>\$80.00</b>
02153-JT33	13S x JT33	102mm	49mm	0 - 1/2"	\$126.00	<b>\$100.00</b>



- Better T.I.R. and rigidity than standard drill chucks
- Taper ground to AT3 accuracy
- Use with keyless jacob's chucks

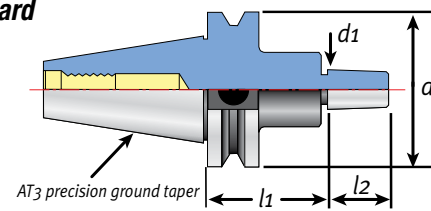

## CAT Tool Holders For Jacobs Taper Drill Chucks

Part No.	Description	l1	l2	d	d1	Jacobs Taper	Price	Sale Price
22511	CAT 40 x JT2 - 1.57"	1.57"	.875"	2.5"	.559"	2	\$84.00	<b>\$65.00</b>
22512	CAT 40 x JT3 - 1.57"	1.57"	1.2"	2.5"	.811"	3	\$84.00	<b>\$65.00</b>
22513	CAT 40 x JT6 - 1.57"	1.57"	.945"	2.5"	.676"	6	\$84.00	<b>\$65.00</b>
22515	CAT 40 x JT33 - 1.57"	1.57"	.945"	2.5"	.624"	33	\$84.00	<b>\$65.00</b>
22521	CAT 50 x JT2 - 1.57"	1.57"	.875"	3.875"	.559"	2	\$125.00	<b>\$100.00</b>
22527	CAT 50 x JT3 - 1.57"	1.57"	1.2"	3.875"	.811"	3	\$125.00	<b>\$100.00</b>
22529	CAT 50 x JT4 - 1.57"	1.57"	1.656"	3.875"	1.124"	4	\$125.00	<b>\$100.00</b>
22531	CAT 50 x JT5 - 1.57"	1.57"	1.875"	3.875"	1.413"	5	\$125.00	<b>\$100.00</b>
22523	CAT 50 x JT6 - 1.57"	1.57"	.945"	3.875"	.676"	6	\$125.00	<b>\$100.00</b>
22525	CAT 50 x JT33 - 1.57"	1.57"	.945"	3.875"	.624"	33	\$125.00	<b>\$100.00</b>

# CAT Morse Taper Precision Holders



- .0002" runout from taper to tool pocket
- Each holder lab certified
- Taper ground to AT3 accuracy

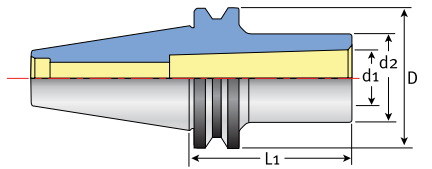

## CAT Morse Taper Tool Holders

Part No.	Taper	Size	L1	d1	d2	D	Price	Sale Price
22611	CAT40 Morse Taper	MT#1	1.75"	.475"	.984"	2.5"	\$96.00	<b>\$75.00</b>
22613	CAT40 Morse Taper	MT#2	2."	.7"	1.26"	2.5"	\$96.00	<b>\$75.00</b>
22615	CAT40 Morse Taper	MT#3	2.75"	.937"	1.575"	2.5"	\$106.75	<b>\$85.00</b>
22617	CAT40 Morse Taper	MT#4	3.75"	1.231"	1.889"	2.5"	\$110.25	<b>\$85.00</b>
22623	CAT50 Morse Taper	MT#2	2.36"	.7"	1.26"	3.875"	\$144.00	<b>\$115.00</b>
22625	CAT50 Morse Taper	MT#3	2.56"	.937"	1.575"	3.875"	\$144.00	<b>\$115.00</b>
22627	CAT50 Morse Taper	MT#4	3.75"	1.231"	1.889"	3.875"	\$147.00	<b>\$115.00</b>
22629	CAT50 Morse Taper	MT#5	4.13"	1.75"	2.48"	3.875"	\$170.00	<b>\$135.00</b>

# Wrenches & Setup Equipment



- For CAT spindles
- Change knobs from bottom
- Bolts right to workbench



## ER Hex, Slotted, and Mini Style Hand Wrenches

Part No.	Description	Nut	Price	Sale Price
894-36	TE-Short hex style	TE Short	\$46.00	<b>\$35.00</b>
04608	ER 11-A hex style	A (Hex)	\$13.00	<b>\$10.00</b>
04609	ER 16-A hex style	A (Hex)	\$13.50	<b>\$10.00</b>
04610	ER 20-A hex style	A (Hex)	\$20.00	<b>\$15.00</b>
04613	ER 16-E slotted style	Slotted	\$35.00	<b>\$25.00</b>
04614	ER 20-E slotted style	Slotted	\$35.00	<b>\$25.00</b>
04615	ER 25-E slotted style	Slotted	\$15.50	<b>\$12.50</b>
04616	ER 32-E slotted style	Slotted	\$20.00	<b>\$15.00</b>
04617	ER 40-E slotted style	Slotted	\$24.00	<b>\$20.00</b>
04618	ER 50-E slotted style	Slotted	\$52.00	<b>\$40.00</b>
04620	ER 8-M mini style	ER Mini	\$12.00	<b>\$10.00</b>
04621	ER 11-M mini style	ER Mini	\$12.00	<b>\$10.00</b>
04622	ER 16-M mini style	ER Mini	\$13.00	<b>\$10.00</b>
04623	ER 20-M mini style	ER Mini	\$14.00	<b>\$11.00</b>
04624	ER 25-M mini style	ER Mini	\$14.00	<b>\$11.00</b>

## Top or Side Mount Fixtures

Part No.	Description	Price	Sale Price
07884	CAT 40 Fixture	\$231.00	<b>\$185.00</b>
07885	CAT 50 Fixture	\$365.00	<b>\$290.00</b>

- For CAT spindles
- Remove contaminants from spindles and holders



Real lambskin provides the best cleaning. Use with any type of machine with a taper of 7/24 CAT, BT or DIN 69871.

## Spindle Wipers

Part No.	Taper	Total	Taper	Price	Sale Price
17707	40	188mm	78mm	\$73.00	<b>\$60.00</b>
17708	50	240mm	120mm	\$73.00	<b>\$60.00</b>

# CAT40 and CAT50 Tap Holders



- Adjustable tension helps start difficult taps
- Quick-Change Style
- Taper ground to AT3 accuracy or better

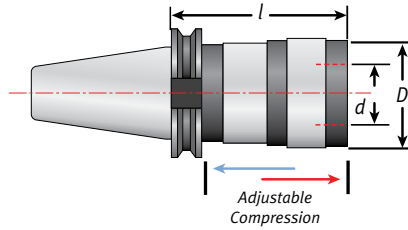

## CAT40 and CAT50 Tension / Compression Tap Holders

Part No.	Description	d	D	l	Capacity	Tension	Comp.	Price	Sale Price
32400/40A	CAT 40 T/C Size 1	0.748"	1.5"	2.36"	0 - 9/16"	0.35"	0.35"	\$295.00	<b>\$235.00</b>
32400/50A	CAT 50 T/C Size 1	0.748"	1.5"	2.44"	0 - 9/16"	0.35"	0.35"	\$395.00	<b>\$315.00</b>
32600/40A	CAT 40 T/C Size 2	1.220"	2.17"	3.94"	5/16 - 7/8"	0.59"	0.59"	\$366.00	<b>\$290.00</b>
32600/50A	CAT 50 T/C Size 2	1.220"	2.17"	3.27"	5/16 - 7/8"	0.59"	0.59"	\$437.00	<b>\$350.00</b>
32800/40A	CAT 40 T/C Size 3	1.890"	3.11"	5.43"	1/2 - 1-3/8"	0.94"	0.94"	\$626.00	<b>\$500.00</b>
32800/50A	CAT 50 T/C Size 3	1.890"	3.11"	5.24"	1/2 - 1-3/8"	0.94"	0.94"	\$661.00	<b>\$525.00</b>
32900/40A	CAT 40 T/C Size 4	2.362"	3.86"	6.06"	1-7/16 - 1-7/8"	1.02"	1.02"	\$1,004.00	<b>\$800.00</b>
32900/50A	CAT 50 T/C Size 4	2.362"	3.86"	5.79"	1-7/16 - 1-7/8"	1.02"	1.02"	\$931.00	<b>\$745.00</b>

## CAT40 and CAT50 Rigid Tap Holders

Part No.	Description	l	D	d	Tap Capacity	Price	Sale Price
21480/40A	CAT 40 Rigid Tap Holder, Size 1	2.32"	1.31"	0.748"	0 - 9/16"	\$199.00	<b>\$160.00</b>
21480/50A	CAT 50 Rigid Tap Holder, Size 1	2.95"	1.31"	0.748"	0 - 9/16"	\$275.00	<b>\$220.00</b>
21680/40A	CAT 40 Rigid Tap Holder, Size 2	3.23"	1.97"	1.22"	5/16 - 7/8"	\$225.00	<b>\$180.00</b>
21680/50A	CAT 50 Rigid Tap Holder, Size 2	3.86"	1.97"	1.22"	5/16 - 7/8"	\$295.00	<b>\$235.00</b>
21880/40A	CAT 40 Rigid Tap Holder, Size 3	4.80"	2.83"	1.89"	1/2 - 1-3/8"	\$250.00	<b>\$200.00</b>
21880/50A	CAT 50 Rigid Tap Holder, Size 3	4.80"	2.83"	1.89"	1/2 - 1-3/8"	\$350.00	<b>\$280.00</b>

# Straight Shank Tap Holders

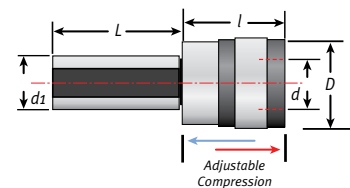

## Straight Shank Tension / Compression Tapping Chucks

Part No.	Description	D1	D	l	L	Capacity	Tension	Comp.	Price	Sale Price
32400/D25.4	1" shank T/C Size 1	1.00"	1.61"	1.76"	1.95"	0 - 9/16"	0.35"	0.35"	\$250.00	<b>\$200.00</b>
32600/D25.4	1" shank T/C Size 2	1.00"	2.36"	2.52"	2.00"	5/16 - 7/8"	0.59"	0.59"	\$299.00	<b>\$240.00</b>
32600/D38.1	1 1/2" shank T/C Size 2	1.50"	2.36"	2.52"	3.50"	5/16 - 7/8"	0.59"	0.59"	\$325.00	<b>\$260.00</b>
32800/D38.1	1 1/2" shank T/C Size 3	1.50"	3.38"	3.85"	3.50"	1/2 - 1-3/8"	0.94"	0.94"	\$468.00	<b>\$375.00</b>

## Straight Shank Rigid Tap Holders

Part No.	Description	d1	L	l	D	d	Tap Capacity	Price	Sale Price
21480/D25.4	1" shank, Rigid Tap Size 1	1.00"	1.95"	1.60"	1.61"	.748"	0 - 9/16"	\$142.00	<b>\$115.00</b>
21680/D25.4	1" shank, Rigid Tap Size 2	1.00"	2.00"	2.50"	2.36"	1.22"	3/8 - 7/8"	\$198.00	<b>\$160.00</b>
21880/D38.1	1 1/2" shank, Rigid Tap Size 3	1.50"	3.50"	3.44"	3.38"	1.89"	1/2 - 1-3/8"	\$253.00	<b>\$200.00</b>

# ANSI Clutch Drive & Rigid Tap Collets



## Clutch Drive Tap Collets

- Prevents broken taps

Size 1	ANSI	Shank	Price	Sale Price
19/1 - 4036	0-6"	0.141"	\$85.00	<b>\$65.00</b>
19/1 - 4041	8, 5/32"	0.168"	\$85.00	<b>\$65.00</b>
19/1 - 4048	10, 3/16"	0.194"	\$85.00	<b>\$65.00</b>
19/1 - 4054	12, 7/32"	0.220"	\$85.00	<b>\$65.00</b>
19/1 - 4063	1/4"	0.255"	\$85.00	<b>\$65.00</b>
19/1 - 4079	5/16"	0.318"	\$85.00	<b>\$65.00</b>
19/1 - 4095	3/8"	0.381"	\$85.00	<b>\$65.00</b>
19/1 - 4111	7/16"	0.323"	\$85.00	<b>\$65.00</b>
19/1 - 4127	1/2"	0.367"	\$85.00	<b>\$65.00</b>
19/1 - 4142	9/16"	0.429"	\$85.00	<b>\$65.00</b>
19/1 - 4097	1/8" NPT	0.437"	\$85.00	<b>\$65.00</b>

Size 2	ANSI	Shank	Price	Sale Price
31/2 - 4079	5/16"	0.318"	\$108.00	<b>\$85.00</b>
31/2 - 4095	3/8"	0.381"	\$108.00	<b>\$85.00</b>
31/2 - 4111	7/16"	0.323"	\$108.00	<b>\$85.00</b>
31/2 - 4127	1/2"	0.367"	\$108.00	<b>\$85.00</b>
31/2 - 4142	9/16"	0.429"	\$108.00	<b>\$85.00</b>
31/2 - 4158	5/8"	0.480"	\$108.00	<b>\$85.00</b>
31/2 - 4174	11/16"	0.542"	\$108.00	<b>\$85.00</b>
31/2 - 4190	3/4"	0.590"	\$108.00	<b>\$85.00</b>
31/2 - 4206	13/16"	0.652"	\$108.00	<b>\$85.00</b>
31/2 - 4222	7/8"	0.697"	\$108.00	<b>\$85.00</b>
31/2 - 4131C	1/4" NPT	0.562"	\$108.00	<b>\$85.00</b>
31/2 - 4166C	3/8" NPT	0.700"	\$108.00	<b>\$85.00</b>
31/2 - 4209C	1/2" NPT		\$108.00	<b>\$85.00</b>

Size 3	ANSI	Shank	Price	Sale Price
48/3 - 4127	1/2"	0.367"	\$250.00	<b>\$200.00</b>
48/3 - 4142	9/16"	0.429"	\$250.00	<b>\$200.00</b>
48/3 - 4158	5/8"	0.480"	\$250.00	<b>\$200.00</b>
48/3 - 4174	11/16"	0.542"	\$250.00	<b>\$200.00</b>
48/3 - 4190	3/4"	0.590"	\$250.00	<b>\$200.00</b>
48/3 - 4206	13/16"	0.652"	\$250.00	<b>\$200.00</b>
48/3 - 4222	7/8"	0.697"	\$250.00	<b>\$200.00</b>
48/3 - 4238	15/16"	0.760"	\$250.00	<b>\$200.00</b>
48/3 - 4254	1"	0.800"	\$250.00	<b>\$200.00</b>
48/3 - 4286	1 1/8, 1 1/16"	0.896"	\$250.00	<b>\$200.00</b>
48/3 - 4317	1 1/4, 1 3/16"	1.021"	\$250.00	<b>\$200.00</b>
48/3 - 4349	1 3/8, 1 5/16"	1.108"	\$250.00	<b>\$200.00</b>
48/3 - 4166C	3/8" NPT	0.700"	\$250.00	<b>\$200.00</b>
48/3 - 4209C	1/2" NPT		\$250.00	<b>\$200.00</b>
48/3 - 4264C	3/4" NPT		\$250.00	<b>\$200.00</b>
48/3 - 4332C	1" NPT		\$250.00	<b>\$200.00</b>



## Rigid Tap Collets

- Change worn taps in seconds

Size 1	ANSI	Shank	Price	Sale Price
19/11-4036	0-6"	0.141"	\$31.00	<b>\$25.00</b>
19/11-4041	8, 5/32"	0.168"	\$31.00	<b>\$25.00</b>
19/11-4048	10, 3/16"	0.194"	\$31.00	<b>\$25.00</b>
19/11-4054	12, 7/32"	0.220"	\$31.00	<b>\$25.00</b>
19/11-4063	1/4"	0.255"	\$31.00	<b>\$25.00</b>
19/11-4079	5/16"	0.318"	\$31.00	<b>\$25.00</b>
19/11-4095	3/8"	0.381"	\$31.00	<b>\$25.00</b>
19/11-4111	7/16"	0.323"	\$31.00	<b>\$25.00</b>
19/11-4127	1/2"	0.367"	\$31.00	<b>\$25.00</b>
19/11-4142	9/16"	0.429"	\$31.00	<b>\$25.00</b>
19/11-4097	1/8" NPT	0.437"	\$31.00	<b>\$25.00</b>

Size 2	ANSI	Shank	Price	Sale Price
31/12-4079	5/16"	0.318"	\$42.00	<b>\$35.00</b>
31/12-4095	3/8"	0.381"	\$42.00	<b>\$35.00</b>
31/12-4111	7/16"	0.323"	\$42.00	<b>\$35.00</b>
31/12-4127	1/2"	0.367"	\$42.00	<b>\$35.00</b>
31/12-4142	9/16"	0.429"	\$42.00	<b>\$35.00</b>
31/12-4158	5/8"	0.480"	\$42.00	<b>\$35.00</b>
31/12-4174	11/16"	0.542"	\$42.00	<b>\$35.00</b>
31/12-4190C	3/4"	0.590"	\$42.00	<b>\$35.00</b>
31/12-4206C	13/16"	0.652"	\$42.00	<b>\$35.00</b>
31/12-4222C	7/8"	0.697"	\$42.00	<b>\$35.00</b>
31/12-4131C	1/4" NPT	0.562"	\$42.00	<b>\$35.00</b>
31/12-4166C	3/8" NPT	0.700"	\$42.00	<b>\$35.00</b>
31/12-4209C	1/2" NPT		\$42.00	<b>\$35.00</b>

Size 3	ANSI	Shank	Price	Sale Price
48/13-4127	1/2"	0.367"	\$115.00	<b>\$90.00</b>
48/13-4142	9/16"	0.429"	\$115.00	<b>\$90.00</b>
48/13-4158	5/8"	0.480"	\$115.00	<b>\$90.00</b>
48/13-4174	11/16"	0.542"	\$115.00	<b>\$90.00</b>
48/13-4190	3/4"	0.590"	\$115.00	<b>\$90.00</b>
48/13-4206	13/16"	0.652"	\$115.00	<b>\$90.00</b>
48/13-4222	7/8"	0.697"	\$115.00	<b>\$90.00</b>
48/13-4238	15/16"	0.760"	\$115.00	<b>\$90.00</b>
48/13-4254	1"	0.800"	\$115.00	<b>\$90.00</b>
48/13-4286	1 1/8, 1 1/16"	0.896"	\$115.00	<b>\$90.00</b>
48/13-4317	1 1/4, 1 3/16"	1.021"	\$115.00	<b>\$90.00</b>
48/13-4349	1 3/8, 1 5/16"	1.108"	\$115.00	<b>\$90.00</b>
48/13-4166C	3/8" NPT	0.700"	\$115.00	<b>\$90.00</b>
48/13-4209C	1/2" NPT		\$115.00	<b>\$90.00</b>
48/13-4264C	3/4" NPT		\$115.00	<b>\$90.00</b>
48/13-4332C	1" NPT		\$115.00	<b>\$90.00</b>

# ER Precision Collets - Inch and Metric Sizes

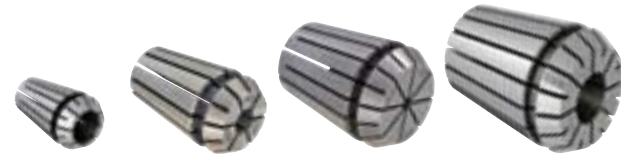

- Standard 0.0004" T.I.R.
- Ultra Precision available - 0.0002" T.I.R.\*
- Collapse range: 0.039"

**Only \$13.50**

All collets inspected for quality before shipping.

\*For Ultra Precision collets put UP in front of the regular part number.

## ER 20 Precision Collets

**Only \$15.00**

Inch	Range	Shank	Metric	Range	Shank
04220-3/32	.054-.093"	3/32"	04220-02	.039-.079"	1-2
04220-1/8	.086-.125"	1/8"	04220-03	.079-.118"	2-3
04220-5/32	.117-.156"	5/32"	04220-04	.118-.157"	3-4
04220-3/16	.148-.187"	3/16"	04220-05	.157-.197"	4-5
04220-7/32	.179-.218"	7/32"	04220-06	.197-.236"	5-6
04220-1/4	.211-.250"	1/4"	04220-07	.236-.276"	6-7
04220-9/32	.242-.281"	9/32"	04220-08	.276-.315"	7-8
04220-5/16	.273-.312"	5/16"	04220-09	.315-.354"	8-9
04220-11/32	.304-.343"	11/32"	04220-10	.354-.394"	9-10
04220-3/8	.336-.375"	3/8"	04220-11	.394-.433"	10-11
04220-13/32	.367-.406"	13/32"	04220-12	.433-.472"	11-12
04220-7/16	.398-.437"	7/16"	04220-13	.472-.512"	12-13
04220-15/32	.429-.468"	15/32"			
04220-1/2	.461-.500"	1/2"			

**Only \$16.00**

## ER 25 Precision Collets

Inch	Range	Shank	Metric	Range	Shank
04225-3/32	.054-.093"	3/32"	04225-02	.039-.079"	1-2
04225-1/8	.086-.125"	1/8"	04225-03	.079-.118"	2-3
04225-5/32	.117-.156"	5/32"	04225-04	.118-.157"	3-4
04225-3/16	.148-.187"	3/16"	04225-05	.157-.197"	4-5
04225-7/32	.179-.218"	7/32"	04225-06	.197-.236"	5-6
04225-1/4	.211-.250"	1/4"	04225-07	.236-.276"	6-7
04225-9/32	.242-.281"	9/32"	04225-08	.276-.315"	7-8
04225-5/16	.273-.312"	5/16"	04225-09	.315-.354"	8-9
04225-11/32	.304-.343"	11/32"	04225-10	.354-.394"	9-10
04225-3/8	.336-.375"	3/8"	04225-11	.394-.433"	10-11
04225-13/32	.367-.406"	13/32"	04225-12	.433-.472"	11-12
04225-7/16	.398-.437"	7/16"	04225-13	.472-.512"	12-13
04225-15/32	.429-.468"	15/32"	04225-14	.512-.551"	13-14
04225-1/2	.461-.500"	1/2"	04225-15	.551-.591"	14-15
04225-17/32	.492-.531"	17/32"	04225-16	.591-.630"	15-16
04225-9/16	.523-.562"	9/16"			
04225-19/32	.554-.593"	19/32"			
04225-5/8	.586-.625"	5/8"			

## ER 11 Precision Collets

Inch	Range	Shank	Metric	Range	Shank
04211-1/16	.043-.062"	1/16"	04211-01.0	.019-.039"	0.5-1.0
04211-3/32	.054-.093"	3/32"	04211-01.5	.039-.059"	1.0-1.5
04211-1/8	.086-.125"	1/8"	04211-02.0	.059-.079"	1.5-2.0
04211-5/32	.117-.156"	5/32"	04211-02.5	.079-.098"	2.0-2.5
04211-3/16	.148-.187"	3/16"	04211-03.0	.098-.118"	2.5-3.0
04211-7/32	.179-.218"	7/32"	04211-03.5	.118-.138"	3.0-3.5
04211-1/4	.211-.250"	1/4"	04211-04.0	.138-.157"	3.5-4.0
			04211-04.5	.157-.177"	4.0-4.5
			04211-05.0	.177-.197"	4.5-5.0
			04211-05.5	.197-.217"	5.0-5.5
			04211-06.0	.217-.236"	5.5-6.0
			04211-06.5	.236-.256"	6.0-6.5
			04211-07.0	.256-.276"	6.5-7.0

**Only \$13.50**

## ER 16 Precision Collets

Inch	Range	Shank	Metric	Range	Shank
04216-1/16	.043-.062"	1/16"	04216-01	.019-.039"	0.5-1
04216-3/32	.054-.093"	3/32"	04216-02	.039-.079"	1-2
04216-1/8	.086-.125"	1/8"	04216-03	.079-.118"	2-3
04216-5/32	.117-.156"	5/32"	04216-04	.118-.157"	3-4
04216-3/16	.148-.187"	3/16"	04216-05	.157-.197"	4-5
04216-7/32	.179-.218"	7/32"	04216-06	.197-.236"	5-6
04216-1/4	.211-.250"	1/4"	04216-07	.236-.276"	6-7
04216-9/32	.242-.281"	9/32"	04216-08	.276-.315"	7-8
04216-5/16	.273-.312"	5/16"	04216-09	.315-.354"	8-9
04216-11/32	.304-.343"	11/32"	04216-10	.354-.394"	9-10
04216-3/8	.336-.375"	3/8"			
04216-13/32	.367-.406"	13/32"			

# ER Precision Collets - Inch and Metric

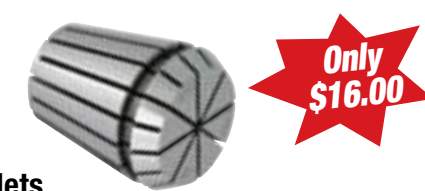

**Only \$16.00**

## ER 32 Precision Collets

Inch	Range	Shank	Metric	Range	Shank
04232-3/32	.054-.093"	3/32"	04232-03	.079-.118"	2-3
04232-1/8	.086-.125"	1/8"	04232-04	.118-.157"	3-4
04232-5/32	.117-.156"	5/32"	04232-05	.157-.197"	4-5
04232-3/16	.148-.187"	3/16"	04232-06	.197-.236"	5-6
04232-7/32	.179-.218"	7/32"	04232-07	.236-.276"	6-7
04232-1/4	.211-.250"	1/4"	04232-08	.276-.315"	7-8
04232-9/32	.242-.281"	9/32"	04232-09	.315-.354"	8-9
04232-5/16	.273-.312"	5/16"	04232-10	.354-.394"	9-10
04232-11/32	.304-.343"	11/32"	04232-11	.394-.433"	10-11
04232-3/8	.336-.375"	3/8"	04232-12	.433-.472"	11-12
04232-13/32	.367-.406"	13/32"	04232-13	.472-.512"	12-13
04232-7/16	.398-.437"	7/16"	04232-14	.512-.551"	13-14
04232-15/32	.429-.468"	15/32"	04232-15	.551-.591"	14-15
04232-1/2	.461-.500"	1/2"	04232-16	.591-.630"	15-16
04232-17/32	.492-.531"	17/32"	04232-17	.630-.669"	16-17
04232-9/16	.523-.562"	9/16"	04232-18	.669-.709"	17-18
04232-19/32	.554-.593"	19/32"	04232-19	.709-.748"	18-19
04232-5/8	.586-.625"	5/8"	04232-20	.748-.787"	19-20
04232-21/32	.617-.656"	21/32"			
04232-11/16	.648-.687"	11/16"			
04232-23/32	.679-.718"	23/32"			
04232-3/4	.711-.750"	3/4"			



## ER 40 Precision Collets

Inch	Range	Shank	Metric	Range	Shank
04240-1/8	.086-.125"	1/8"	04240-04	.118-.157"	3-4
04240-5/32	.117-.156"	5/32"	04240-05	.157-.197"	4-5
04240-3/16	.148-.187"	3/16"	04240-06	.197-.236"	5-6
04240-7/32	.179-.218"	7/32"	04240-07	.236-.276"	6-7
04240-1/4	.211-.250"	1/4"	04240-08	.276-.315"	7-8
04240-9/32	.242-.281"	9/32"	04240-09	.315-.354"	8-9
04240-5/16	.273-.312"	5/16"	04240-10	.354-.394"	9-10
04240-11/32	.304-.343"	11/32"	04240-11	.394-.433"	10-11
04240-3/8	.336-.375"	3/8"	04240-12	.433-.472"	11-12
04240-13/32	.367-.406"	13/32"	04240-13	.472-.512"	12-13
04240-7/16	.398-.437"	7/16"	04240-14	.512-.551"	13-14
04240-15/32	.429-.468"	15/32"	04240-15	.551-.591"	14-15
04240-1/2	.461-.500"	1/2"	04240-16	.591-.630"	15-16
04240-17/32	.492-.531"	17/32"	04240-17	.630-.669"	16-17
04240-9/16	.523-.562"	9/16"	04240-18	.669-.709"	17-18
04240-19/32	.554-.593"	19/32"	04240-19	.709-.748"	18-19
04240-5/8	.586-.625"	5/8"	04240-20	.748-.787"	19-20
04240-21/32	.617-.656"	21/32"	04240-21	.787-.827"	20-21
04240-11/16	.648-.687"	11/16"	04240-22	.827-.866"	21-22
04240-23/32	.679-.718"	23/32"	04240-23	.866-.906"	22-23
04240-3/4	.711-.750"	3/4"	04240-24	.906-.945"	23-24
04240-7/8	.836-.875"	7/8"	04240-25	.945-.984"	24-25
04240-1	.961-1.00"	1"	04240-26	.984-1.024"	25-26



- Standard 0.0004" T.I.R.
- Ultra Precision 0.0002" T.I.R.\*
- Collapse range: 0.039"

All collets inspected for quality before shipping.

\*For Ultra Precision collets put UP in front of the regular part number.

## ER Collet Sets (inch and metric)

Inch	Part No.	Range	Pcs.	Collets Included	Sale Price	Metric	Part No.	Range	Pcs.	Collets Included	Sale Price
ER11	04208IS	1/32-1/4"	7	1/16-1/4" by 32 <sup>nds</sup>	\$90.00	ER11	04201MS	0.5-7mm	13	1-7 by 0.5mm	\$160.00
ER16	04209IS	1/16-3/8"	10	3/32-3/8" by 32 <sup>nds</sup>	\$120.00	ER16	04202MS	0.5-10mm	10	1-10 by 1mm	\$120.00
ER20	04210IS	1/8-1/2"	12	5/32-1/2" by 32 <sup>nds</sup>	\$165.00	ER20	04203MS	1-13mm	12	2-13 by 1mm	\$165.00
ER25	04211IS	1/8-5/8"	16	5/32-5/8" by 32 <sup>nds</sup>	\$230.00	ER25	04204MS	1-16mm	15	2-16 by 1mm	\$225.00
ER32	04212IS	3/16-3/4"	18	7/32-3/4" by 32 <sup>nds</sup>	\$260.00	ER32	04205MS	2-20mm	18	3-20 by 1mm	\$260.00
ER40	04213IS	1/8-1"	13	1/8-1.0" by 16 <sup>ths</sup>	\$215.00	ER40	04206MS	3-26mm	23	4-26 by 1mm	\$390.00

Ph: (800) 445-1068 or (440) 968-3228 • Fax: (440) 968-3611 • e-mail: sales@hemlytool.com

# Steel Sealed ER Coolant Collets - Inch & Metric



- Sealed to 2000 PSI
- No plugs to fail
- Ideal for "lights out" operations

Designed for use with on-size tools.  
Use with ER, RD, DR, ESX or BR collet chucks.

**Only \$35.00**

## ER 16 Inch Size

Part No.	Shank
04543-3/32	3/32"
04543-1/8	1/8"
04543-5/32	5/32"
04543-3/16	3/16"
04543-7/32	7/32"
04543-1/4	1/4"
04543-9/32	9/32"
04543-5/16	5/16"
04543-11/32	11/32"
04543-3/8	3/8"
04543-13/32	13/32"

## ER 16 Metric Size

Part No.	Shank
04543-03	3mm
04543-04	4mm
04543-05	5mm
04543-06	6mm
04543-07	7mm
04543-08	8mm
04543-09	9mm
04543-10	10mm

**Only \$35.00**

## ER 20 Inch Size

Part No.	Shank
04544-5/32	5/32"
04544-3/16	3/16"
04544-7/32	7/32"
04544-1/4	1/4"
04544-9/32	9/32"
04544-5/16	5/16"
04544-11/32	11/32"
04544-3/8	3/8"
04544-13/32	13/32"
04544-7/16	7/16"
04544-15/32	15/32"
04544-1/2	1/2"

## ER 20 Metric Size

Part No.	Shank
04544-03	3mm
04544-04	4mm
04544-05	5mm
04544-06	6mm
04544-07	7mm
04544-08	8mm
04544-09	9mm
04544-10	10mm
04544-11	11mm
04544-12	12mm
04544-13	13mm

**Only \$35.00**

## ER 25 Inch Size

Part No.	Shank
04545-7/32	7/32"
04545-1/4	1/4"
04545-9/32	9/32"
04545-5/16	5/16"
04545-11/32	11/32"
04545-3/8	3/8"
04545-13/32	13/32"
04545-7/16	7/16"
04545-15/32	15/32"
04545-1/2	1/2"
04545-17/32	17/32"
04545-9/16	9/16"
04545-19/32	19/32"
04545-5/8	5/8"

## ER 25 Metric Size

Part No.	Shank
04545-03	3mm
04545-04	4mm
04545-05	5mm
04545-06	6mm
04545-07	7mm
04545-08	8mm
04545-09	9mm
04545-10	10mm
04545-11	11mm
04545-12	12mm
04545-13	13mm
04545-14	14mm
04545-15	15mm
04545-16	16mm

**Only \$40.00**

## ER 32 Inch Size

Part No.	Shank
04546-7/32	7/32"
04546-1/4	1/4"
04546-9/32	9/32"
04546-5/16	5/16"
04546-11/32	11/32"
04546-3/8	3/8"
04546-13/32	13/32"
04546-7/16	7/16"
04546-15/32	15/32"
04546-1/2	1/2"
04546-19/32	19/32"
04546-9/16	9/16"
04546-21/32	21/32"
04546-5/8	5/8"
04546-23/32	23/32"
04546-3/4	3/4"

## ER 32 Metric Size

Part No.	Shank
04546-03	3mm
04546-04	4mm
04546-05	5mm
04546-06	6mm
04546-07	7mm
04546-08	8mm
04546-09	9mm
04546-10	10mm
04546-11	11mm
04546-12	12mm
04546-13	13mm
04546-14	14mm
04546-15	15mm
04546-16	16mm
04546-17	17mm
04546-18	18mm
04546-19	19mm
04546-20	20mm

**Only \$45.00**

## ER 40 Inch Size

Part No.	Shank
04547-3/8	3/8"
04547-13/32	13/32"
04547-7/16	7/16"
04547-15/32	15/32"
04547-1/2	1/2"
04547-17/32	17/32"
04547-9/16	9/16"
04547-19/32	19/32"
04547-5/8	5/8"
04547-21/32	21/32"
04547-11/16	11/16"
04547-23/32	23/32"
04547-3/4	3/4"
04547-7/8	7/8"
04547-1	1.0"

## ER 40 Metric Size

Part No.	Shank
04547-06	6mm
04547-08	8mm
04547-10	10mm
04547-11	11mm
04547-12	12mm
04547-13	13mm
04547-14	14mm
04547-16	16mm
04547-18	18mm
04547-20	20mm
04547-25	25mm



# CAT40, CAT50, Retention Knobs



- All mating surfaces precision ground
- Manufactured to the highest standards for maximum safety and long life
- Hardened for maximum longevity

Please make sure that the Retention Knob you order is the correct one for your machine. Using the wrong Retention Knob can cause damage to your machine spindle, the tool holder, and may create a safety hazard.

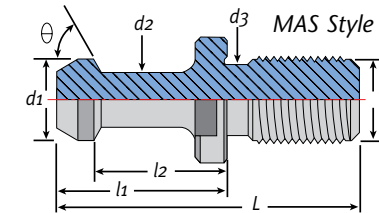
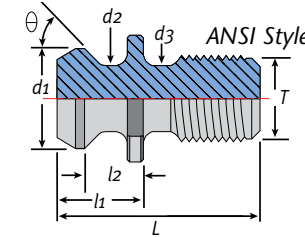

## CAT Standard Retention Knobs

Part No.	Type	θ	d1	d2	d3	L	l1	l2	T	Price	Sale Price
21006-15	CAT 40-DIN	15°	.75"	0.55"	0.640"	1.88"	1.024"	.787"	5/8 - 11"	\$32.00	<b>\$20.00</b>
21007-15	CAT 40-DIN	15°	.75"	0.55"	-	1.89"	1.028"	.792"	5/8 - 11"	\$32.00	<b>\$20.00</b>
21003	CAT 40-ANSI	45°	0.740"	0.490"	0.490"	1.50"	0.640"	.440"	5/8 - 11"	\$15.40	<b>\$12.00</b>
21003-45	CAT 40-MAS-I	45°	0.590"	0.394"	0.512"	2.25"	1.266"	.990"	5/8 - 11"	\$15.40	<b>\$12.00</b>
21003-60	CAT 40-MAS-II	60°	0.590"	0.394"	0.512"	2.25"	1.266"	.990"	5/8 - 11"	\$15.40	<b>\$12.00</b>
21003-90	CAT 40-MAS-III	90°	0.590"	0.394"	0.512"	2.25"	1.266"	.990"	5/8 - 11"	\$15.40	<b>\$12.00</b>
21005-45	CAT 50-MAS-I	45°	0.906"	0.669"	0.827"	3.346"	1.772"	1.378"	1 - 8"	\$21.00	<b>\$16.50</b>
21005-60	CAT 50-MAS-II	60°	0.906"	0.669"	0.827"	3.346"	1.772"	1.378"	1 - 8"	\$21.00	<b>\$16.50</b>
21005-90	CAT 50-MAS-III	90°	0.906"	0.669"	0.827"	3.346"	1.772"	1.378"	1 - 8"	\$21.00	<b>\$16.50</b>
21008-15	CAT 50-DIN	15°	1.101"	0.825"	-	2.640"	1.338"	.984"	1 - 8"	\$35.00	<b>\$28.00</b>
21005	CAT 50-ANSI	45°	1.140"	0.820"	0.820"	2.30"	1.00"	.700"	1 - 8"	\$21.00	<b>\$16.50</b>

## CAT Coolant Style Retention Knobs

Part No.	Type	θ	d1	d2	d3	L	l1	l2	T	Price	Sale Price
21006-15C	CAT 40-DIN Coolant	15°	.75"	0.55"	0.640"	1.88"	1.024"	.787"	5/8 - 11"	\$35.00	<b>\$20.00</b>
21007-15C	CAT 40-DIN Coolant	15°	.75"	0.55"	-	1.89"	1.028"	.792"	5/8 - 11"	\$15.40	<b>\$12.00</b>
21003-C	CAT 40-ANSI-C	45°	0.740"	0.490"	0.490"	1.50"	0.640"	.440"	5/8 - 11"	\$15.40	<b>\$12.00</b>
21003-45C	CAT 40-Coolant-I	45°	0.590"	0.394"	0.512"	2.25"	1.266"	.990"	5/8 - 11"	\$15.40	<b>\$12.00</b>
21003-60C	CAT 40-Coolant-II	60°	0.590"	0.394"	0.512"	2.25"	1.266"	.990"	5/8 - 11"	\$15.40	<b>\$12.00</b>
21003-90C	CAT 40-Coolant-III	90°	0.590"	0.394"	0.512"	2.25"	1.266"	.990"	5/8 - 11"	\$15.40	<b>\$12.00</b>
21005-45C	CAT 50-Coolant-I	45°	0.906"	0.669"	0.827"	3.346"	1.772"	1.378"	1 - 8"	\$21.00	<b>\$16.50</b>
21005-60C	CAT 50-Coolant-II	60°	0.906"	0.669"	0.827"	3.346"	1.772"	1.378"	1 - 8"	\$21.00	<b>\$16.50</b>
21005-90C	CAT 50-Coolant-III	90°	0.906"	0.669"	0.827"	3.346"	1.772"	1.378"	1 - 8"	\$21.00	<b>\$16.50</b>
21008-15C	CAT 50-DIN Coolant	15°	1.101"	0.825"	-	2.640"	1.338"	.984"	1 - 8"	\$41.00	<b>\$32.00</b>
21005-C	CAT 50-ANSI-C	45°	1.140"	0.820"	0.820"	2.30"	1.00"	.700"	1 - 8"	\$21.00	<b>\$16.50</b>



## Pocket Big Savings on these specially priced CAT40 or CAT50 tooling packages from Techniks & Hemly

### CAT40 Tooling Package

### CAT50 Tooling Package



**Save \$719**

**Save \$606**

**Sale: \$1,690** (original price \$2,409)

**Sale: \$2,370** (original price \$2,976)

#### No. TP-C40, 43 Piece CAT 40 Tooling Package

#### No. TP-C50, - 45 Piece CAT50 Tooling Package

Qty.	Part No.	Description	Price	Extension
4	22253	CAT 40 x ER 32 - 2.76	\$153.00	\$612.00
2	22225	CAT 40 x ER 16 - 2.76	\$143.00	\$286.00
1	04212IS	ER 32 x 18 piece collet set - Inch	\$486.00	\$486.00
1	04209IS	ER 16 x 10 piece collet set - Inch	\$233.50	\$233.50
1	22911	CAT 40 x SLN 1/4" - 3"	\$85.00	\$85.00
1	22915	CAT 40 x SLN 3/8" - 3"	\$85.00	\$85.00
1	22917	CAT 40 x SLN 1/2" - 3"	\$85.00	\$85.00
1	22919	CAT 40 x SLN 5/8" - 3"	\$85.00	\$85.00
1	22921	CAT 40 x SLN 3/4" - 3.5"	\$95.00	\$95.00
1	22925	CAT 40 x SLN 1" - 4"	\$95.00	\$95.00
1	22403	CAT 40 x SPU 1/2" - 4"	\$228.00	\$228.00
1	04616	ER 32 - E WRENCH	\$20.00	\$20.00
1	04609	ER 16 - A WRENCH	\$13.50	\$13.50

Qty.	Part No.	Description	Price	Extension
5	22291	CAT 50 x ER 20 - 4	\$180.00	\$900.00
5	22311	CAT 50 x ER 32 - 4	\$170.00	\$850.00
1	04212IS	ER 32 x 18 piece collet set - in.	\$486.00	\$486.00
1	04210IS	ER 20 x 12 piece collet set - in.	\$306.00	\$306.00
2	22945	CAT 50 x SLN 1 - 4	\$130.00	\$260.00
1	22947	CAT 50 x SLN 1-1/4 - 4.6	\$134.00	\$134.00
1	04610	ER 20 - A wrench	\$20.00	\$20.00
1	04616	ER 32 - E wrench	\$20.00	\$20.00

Custom tooling packages available. Call for a fast quote.

[www.hemlytool.com](http://www.hemlytool.com)

**HEADQUARTERS: HEMLY TOOL SUPPLY INC.**  
 9700 Madison Road, Montville, OH 44064  
 1-800-445-1068 • Tel: 440-968-3228  
 Fax: 440-968-3611 • e-mail: [sales@hemlytool.com](mailto:sales@hemlytool.com)

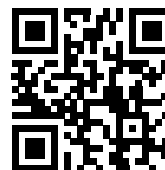

**CT BRANCH: HEMLY TOOL SUPPLY OF CT, LLC**  
 111 Pane Road, Newington, CT 06111  
 1-888-474-1300 • Tel: 860-436-4570  
 Fax: 860-436-4807 • e-mail: [jon@hemlytool.com](mailto:jon@hemlytool.com)