

EVEREDE TOOL COMPANY

Indexable tooling since 1932

2017 1st Quarter Promos

January 1st thru February 28th

THREE UNIQUE PRODUCT LINES AVAILABLE FROM EVEREDE TOOL COMPANY

Indexable Mini Set (Holder With Inserts)

Save Big 25% Off

Features >>>

- Benefiting from the specially ground dual-flute insert and optimized coating, higher feed rates and cutting speeds can be achieved on chamfering operations.
- Each insert has 4 cutting edges, reducing cost of inserts.
- Fine edge honing cutting edges, good chip breaking condition and long tool life.
- C70 holder has (2) flutes
- C20 holder has (4) flutes

Inserts >>>

- Max Chamfering .06P
- NC2022 - K20F grade, ATIN coated. The 1st choice for high carbon, High alloy and hardened steels as well as cast iron.
- NC2071 - K20F grade, TiN coated, high positive rake angle and honed sharp edge. The best choice for low carbon steel, low carbon alloy steel, stainless steel, Al, Al alloy, Brass, Bronze and most of the non-ferrous metal.

Part No.	Chamfering	Max. Dia.	Max. Length	Max. Feed	Max. Speed	Max. RPM	Max. Torque	Max. Power	Max. Temp.	Max. Life	Max. Cost
20088	MINI-C8-10-02	1.0	1.0	0.01	100	1000	100	100	100	100	100
20089	MINI-C8-10-03	1.0	1.0	0.01	100	1000	100	100	100	100	100
20090	MINI-C8-10-04	1.0	1.0	0.01	100	1000	100	100	100	100	100
20091	MINI-C8-10-05	1.0	1.0	0.01	100	1000	100	100	100	100	100

EVEREDE TOOL COMPANY
5206 N. Northwest Highway Chicago, Illinois 60630 / TEL: 800-621-6486
Visit www.everede.net for detailed product information.

EVEREDE MINI SETS PROMO

ANSI BAR PROMO 25% Off

Order By This Number

EDP Numbers	Everede Part Numbers	Insert	Contents	Shank	Min. Size	Max. Length	List Price	Promo Price
01134	EH8R-SC-LCR-27L120-M5	CGGT-21.53 TL120	(1) carbide bar (2) TiAlN coated carbide inserts	500	400	8	\$170.00	\$127.50
01135	EH8R-SC-LCR-27L120-M5	CGGT-21.53 TL120	(1) insert wrench	500	400	8	\$170.00	\$127.50
01136	EH8R-SC-LPR-27L120-M5	CPGT-21.53 TL120	(1) carbide bar (2) TiAlN coated carbide inserts	500	400	8	\$170.00	\$127.50
01137	EH8R-SC-LPR-27L120-M5	CPGT-21.53 TL120	(1) insert wrench	500	400	8	\$170.00	\$127.50

Work Material	SPK	Max. Feed	Max. RPM	Industries	Material Groups	Benefits
High Temp Alloys	40-100	0.01-0.12	200-2000	Aerospace	High Temp Alloys	Partners will wet or dry
Stainless Steel	250-500	0.01-0.12	200-2000	Automotive	Stainless Steel	Marked chip groove
Steel	300-900	0.01-0.12	200-2000	Power Generation	General Purpose	Universal grade
Cast Iron	200-1500	0.01-0.12	200-2000	Automotive	Cast Iron	Ground inserts

THE ONE
TL120 grade suitable for multiple industries, broad range of material groups, and wide range of applications.

EVEREDE TOOL COMPANY
Large size - Hands Inventory
We have deeper stocks
Fast delivery on modifications and specials.
We want to be your one choice for every insert and boring bar.
Contact us for the industry

MADE IN USA

Dümmel premium carbide cutting tools

MINICUT NEW EXPANDED INCH SIZES!
grooving, boring and profiling

1ST QUARTER PROMO BUY ANY 5 INSERTS BELOW GET 1 FREE

PLEASE USE PROMO CODE 1Q17

MINICUT Benefits:

- More inch sizes, interchangeable with most competitors.
- Blank coated grade at a great price.

Right-hand (R) or left-hand (L) cutting edge. Minimum to max.

EDP Number	Part Number	Inch Size	Length	Max. Feed	Max. RPM	Max. Torque	Max. Power	Max. Temp.	Max. Life	Max. Cost
7225F	R508-157-02	1.125	0.001	0.2	1.8	3.3	6	0.2	1.8	1.8
7226F	R511-157-02	1.125	0.001	0.2	1.8	3.3	6	0.2	1.8	1.8
7227F	R515-157-02	1.125	0.001	0.2	1.8	3.3	6	0.2	1.8	1.8
7228F	R519-157-02	1.125	0.001	0.2	1.8	3.3	6	0.2	1.8	1.8
7229F	R523-157-02	1.125	0.001	0.2	1.8	3.3	6	0.2	1.8	1.8

For A List Of Complete Sizes Available Visit www.duemmel.net

ULTRAMINI

ULTRAMINI PROMO KIT = \$384⁹⁹ \$250⁰⁰

Benefits of the Ultramini System

- Sharpest cutting edge in the industry - Longer tool life
- Reduced cutting forces
- Exists in Medical and Aerospace materials
- Extremely repeatable
- .0004" Axial and Radial repeatability
- Precision ground shanks
- 3 insert clamping screws
- Distinct advantages
- Coated channel in the shank
- 2 holders accommodate 100% of inserts
- Holder prices are more economical than competitors

KIT ORDER INFO
KIT No. 72276
Description: SETS-UM-0750
No Promo Code Necessary

EDP Number	Qty	Description	Long Description
72276	1	ULTRAMINI	UM-0750 (1) 1/2" Min. 0.04" Spikes
72277	1	ULTRAMINI	UM-0750 (2) 1/2" Min. 0.04" Spikes
72278	1	ULTRAMINI	UM-0750 (3) 1/2" Min. 0.04" Spikes
72279	1	ULTRAMINI	UM-0750 (4) 1/2" Min. 0.04" Spikes

New ULTRAMINI Tools
GEOMETRIES, SUBSTRATES AND COATINGS DESIGNED FOR SPECIFIC INDUSTRIES.
MEDICAL: Medical Line XTRALINE: Aerospace Line HARDLINE: Hard Part Machining

EVEREDE TOOL COMPANY
5206 N. Northwest Highway Chicago, Illinois 60630 / TEL: 800-621-6486
Visit www.everede.net for detailed product information.

New Products & Literature

One Tool Performs Multiple Applications

K P I N S

NC Helix Drill Helical Interpolation Cat. 04

EVEREDE TOOL COMPANY

NEW PRODUCTS NOW AVAILABLE

Custom Tooling

2017

MADE IN USA

Dümmel premium carbide cutting tools

New ULTRAMINI Tools
GEOMETRIES, SUBSTRATES AND COATINGS DESIGNED FOR SPECIFIC INDUSTRIES.
MEDICAL: Medical Line XTRALINE: Aerospace Line HARDLINE: Hard Part Machining

ULTRAMINI

New MINICUT Tools
Inch Width with Radial - Larger T, max. Spikes Insert, Insert with Chip Breaker

MINICUT

Visit www.duemmel.net for detailed product information.



Everede is the exclusive Marketer and Importer for Nine9 & Duemmel



EVEREDE MINI SETS PROMO

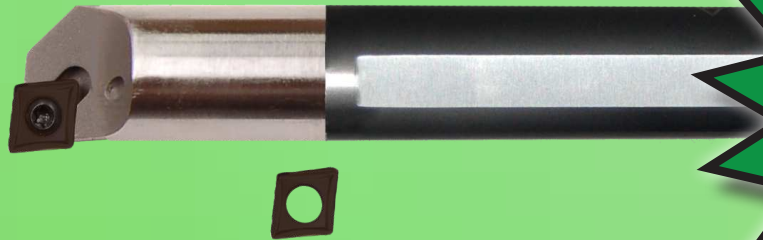

Order By This Number

**ANSI BAR
PROMO
25% Off**

Promotional Period:
1/1/17 - 2/28/17
or While Supplies Last
Terms & Conditions May Apply

EDP Numbers	Description	Insert	Contents	Shank	Min Bore	OAL	List Price	Promo Price
01334	E08R SCLCR-2/TL120 MS	CCGT-21.51 TL120	(1) carbide bar	.500	.600	8	\$226.36	\$170.00
01335	E08R SCLCR-3/TL120 MS	CCGT-32.51 TL120	(2) TiALN coated carbide inserts (1) insert wrench	.500	.600	8	\$226.36	\$170.00
01336	E08R SCLPR-2/TL120 MS	CPGT-21.51 TL120	(1) carbide bar	.500	.600	8	\$226.36	\$170.00
01337	E08R SCLPR-3/TL120 MS	CPGT-32.51 TL120	(2) TiALN coated carbide inserts (1) insert wrench	.500	.600	8	\$226.36	\$170.00

Work Material	SFM	Max in/rev		Max DOC		Industries	Material Groups	Benefits
		21.51	32.51	21.51	32.51			
High Temp Alloys	60-300	.010	.012	.020	.090	Aerospace Medical Power Generation Automotive	High Temp Alloys Stainless Steel General Purpose Cast Iron	Performs well wet or dry Molded chip groove Universal grade Ground insert
Stainless Steel	250-800	.010	.012	.020	.090			
Steel	300-900	.010	.012	.020	.090			
Cast Iron	200-1500	.010	.012	.020	.090			

THE ONE

TL120 grade suitable for multiple industries, broad range of material groups, and wide range of applications.



- Large On -Hand Inventory
- We Bore Deeper Better.
- Fast Delivery On Modifications And Specials.
- We Want To Be Your First Choice For Screw On Insert Boring Bars.
- Best Prices In The Industry





Indexable Mini Set

(Holder With 2 Inserts)

Save Big
25% Off

Face Milling

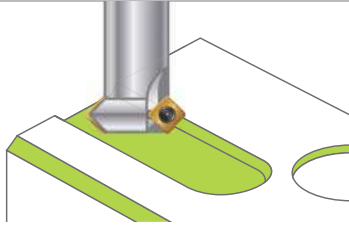

Chamfering

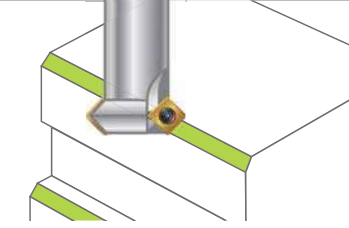

Back Chamfering

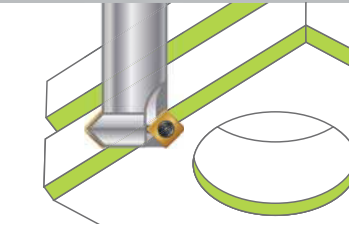

Countersink

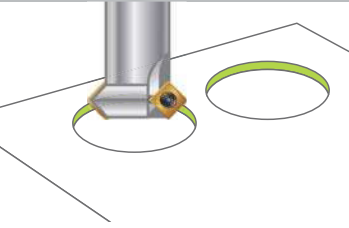

Back Circular Chamfering

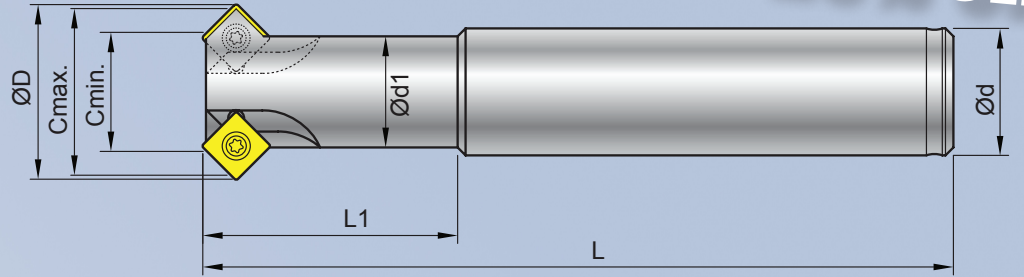
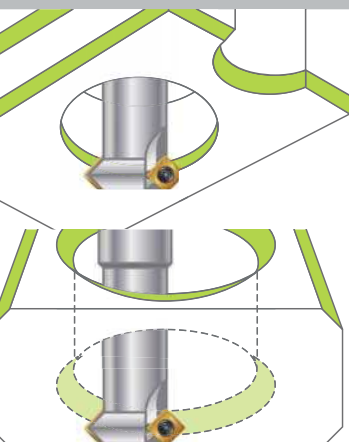

EDP No.	Description	ØD	Ød	Ød1	L	L1	Cmax.	Cmin.	Insert	Content	List Price	Promo Price
20096	99616-C10-32-02S	12	10	7.5	60	15	11	7	N9GX04T002-NC2032	1 x Holder 2 x Inserts	\$210.70	\$160.00
20097	99616-C10-71-02S	12	10	7.5	60	15	11	7	N9GX04T002-NC9071	1 x Key		
20098	99616-C20-32-02S	16.2	12	9.6	100	25	16	11	N9GX04T002-NC2032	1 x Holder 4 x Inserts	\$253.40	\$190.00
20099	99616-C20-71-02S	16.2	12	9.6	100	25	16	11	N9GX04T002-NC9071	1 x Key		

** For Complete Tool Data & Cutting Parameters Visit www.Everede.net **

► Features >>

- Benefitting from the specially ground dual-relief insert and optimized coating, higher feed rates and cutting speeds can be achieved on chamfering operations.
- Each insert has **4 cutting edges**, reducing cost of inserts.
- Fine edge honning cutting edge, good chip breaking condition and long tool life.
- C10 holder has (2) flutes
- C20 holder has (4) flutes

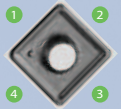

NC2032

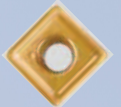

NC9071

► Inserts >> Max Chamfering .059"

NC2032: • K20F grade, AlTiN coated. The 1st choice for high carbon, high alloy and hardened steels as well as cast iron.

NC9071: • K20F grade, TiN coated, high positive rake angle and honed sharp edge.

The best choice for low carbon steel, low carbon alloy steel, stainless steel, Al, Al-alloy, Brass, Bronze and most of the non-ferrous metal.

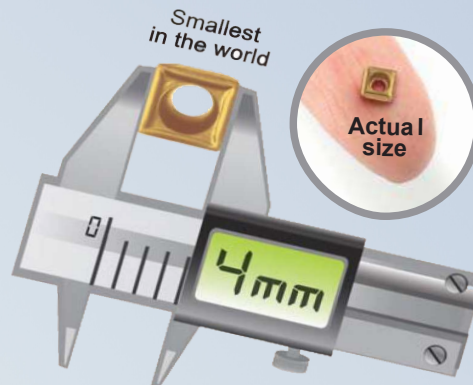

E® **EVEREDE TOOL COMPANY**

5296 N. Northwest Highway Chicago, Illinois 60630 / TEL: 800-621-5486
Visit www.everede.net for detailed product information.

Promotional Period: 1/1/17 - 2/28/17
While Supplies Last Terms & Conditions May Apply

MINICUT

grooving, boring and profiling

Minicut Benefits:

- New Inch Sizes.
- Interchangeable with most competitors.
- **TiALN coated grade at a great price.**

Right hand (R): as shown.
 Left hand (L): mirror image.
 Dimensions in mm.

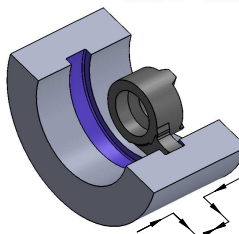
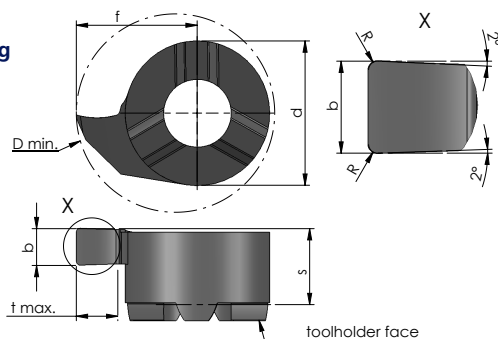

1ST QUARTER PROMO
BUY ANY 5 INSERTS BELOW
GET 1 FREE

PLEASE USE
 PROMO CODE
1Q17

EDP number (order number)	Description	b +0.03	b (inch)	R	f	s	d	Ap max.*	t max.	D min.	U.S.A. Stock		Toolholder type	List price
											AL41F			
73571 [†]	RS08.079.02	0.79	0.031 [″]	0.2	4.8	3.3	6	0.2	1.0	8	●			
72275 [†]	RS08.117.02	1.17	0.046 [″]	0.2	4.8	3.3	6	0.2	1.0	8	●	611	\$19.39	
73575 [†]	RS08.157.02	1.57	0.062 [″]	0.2	4.8	3.3	6	0.2	1.0	8	●			
72267 [†]	RS11.078.02	0.78	0.031 [″]	0.2	6.7	4.2	8	0.2	2.3	11	●			
72268 [†]	RS11.117.02	1.17	0.046 [″]	0.2	6.7	4.2	8	0.2	2.3	11	●	608	\$19.25	
72269 [†]	RS11.157.02	1.57	0.062 [″]	0.2	6.7	4.2	8	0.2	2.3	11	●			

*Ap max. = maximum depth of cut (depending on material). Order example: right hand version and grade RS14.200.02/AL41F. Left hand available upon request. †=New Expanded Inch Items

For A List Of Complete Sizes Available Visit www.everede.net

ULTRAMINI

ULTRAMINI PROMO KIT = ~~\$384⁰⁸~~ \$250⁰⁰



Comes with integrated lid, not shown.

KIT ORDER INFO

EDP No.
72276

Description
SET63-UM-0750

No Promo Code
Necessary

Benefits of the Ultramini System

- Sharpest cutting edge in the industry
 - Longer tool life
 - Reduced cutting forces
 - Excels in Medical and Aerospace materials
- Extremely repeatable
 - .0004" Axial and Radial repeatability
 - Precision ground shanks
 - 2 insert clamping screws
- Distinct advantages
 - Coolant channel in the shank
 - 2 holders accommodate 1000s of inserts
 - Holder prices are more economical than competitors

Each Kit contains:

EDP Number	QTY	Description	Long Description
70727	1	645.G01905-D	19.05 mm (.75") x 90 mm (3.54") holder
70744	1	676.G01905-D	
71907	2	R050.3-16/AL4F	3 mm (.118") x 16 mm (.628") loc UM insert
72008	2	R050.6-35/AL4F	6 mm (.236") x 16 mm (1.378") loc UM insert

All in a convenient case with molded foam insert, as shown on the left.

New ULTRAMINI Tools

GEOMETRIES, SUBSTRATES AND COATINGS DESIGNED FOR SPECIFIC INDUSTRIES:

MEDILINE: Medical Line

XTRALINE: Aerospace Line

HARDLINE: Hard Part Machining

Contact us to discover the unique characteristics of these specialized tools.